

BASIX C STATION METRIC STYLE

Cat. No. 1845 — Driver Assembly includes:
7 & 8

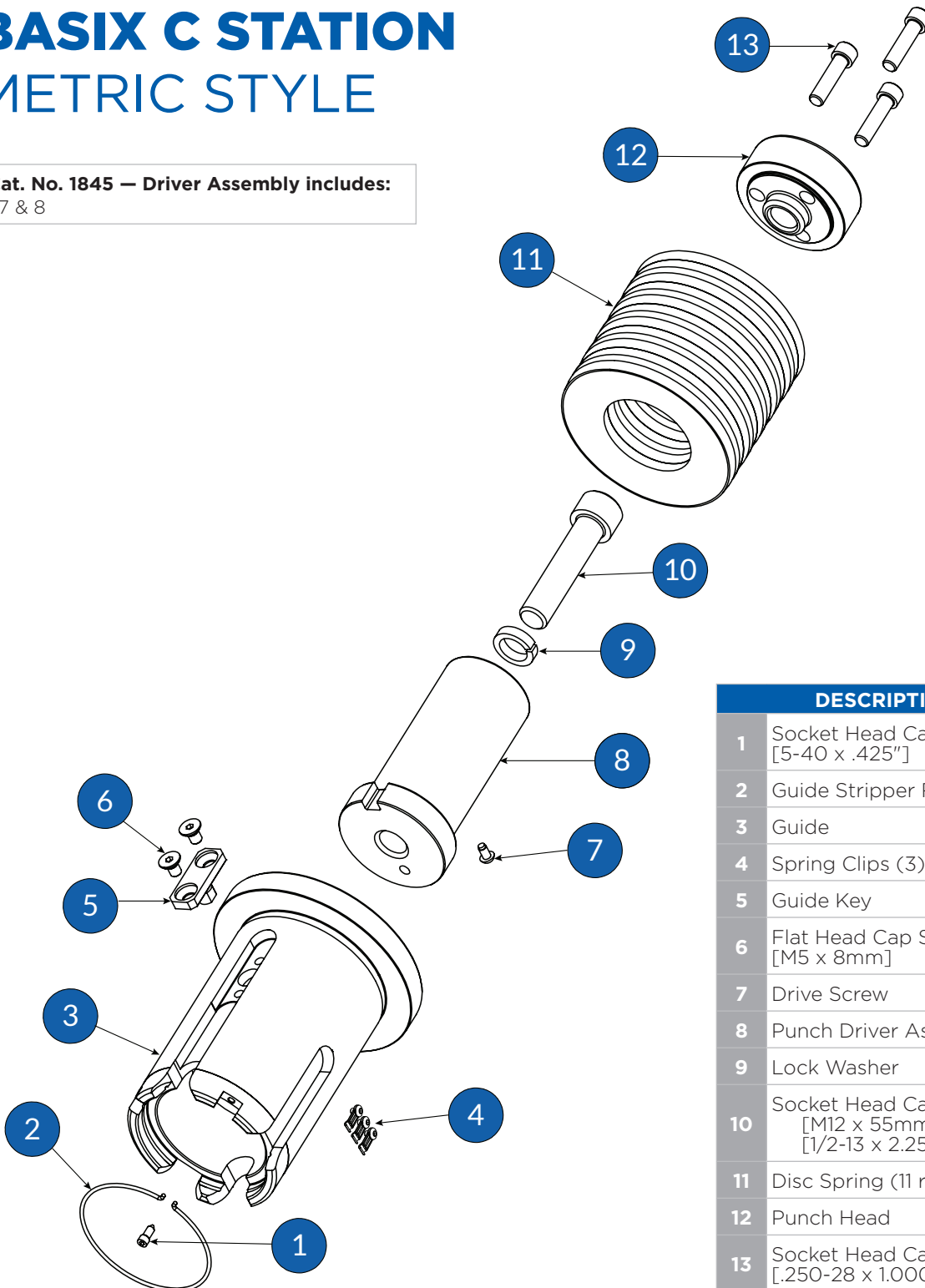

	DESCRIPTION	CAT. NO.
1	Socket Head Cap Screw [5-40 x .425"]	429
2	Guide Stripper Ring	5035
3	Guide	1846
4	Spring Clips (3)	2810
5	Guide Key	1834
6	Flat Head Cap Screw [M5 x 8mm]	6567
7	Drive Screw	6666
8	Punch Driver Assembly	1845
9	Lock Washer	432
10	Socket Head Cap Screw (2) [M12 x 55mm] [1/2-13 x 2.250"]	6026 6002
11	Disc Spring (11 required)	1844
12	Punch Head	1843
13	Socket Head Cap Screw [.250-28 x 1.000"]	6047