

BASIX E STATION METRIC STYLE

Cat. No. 1874 — Driver Assembly includes:
9 & 10

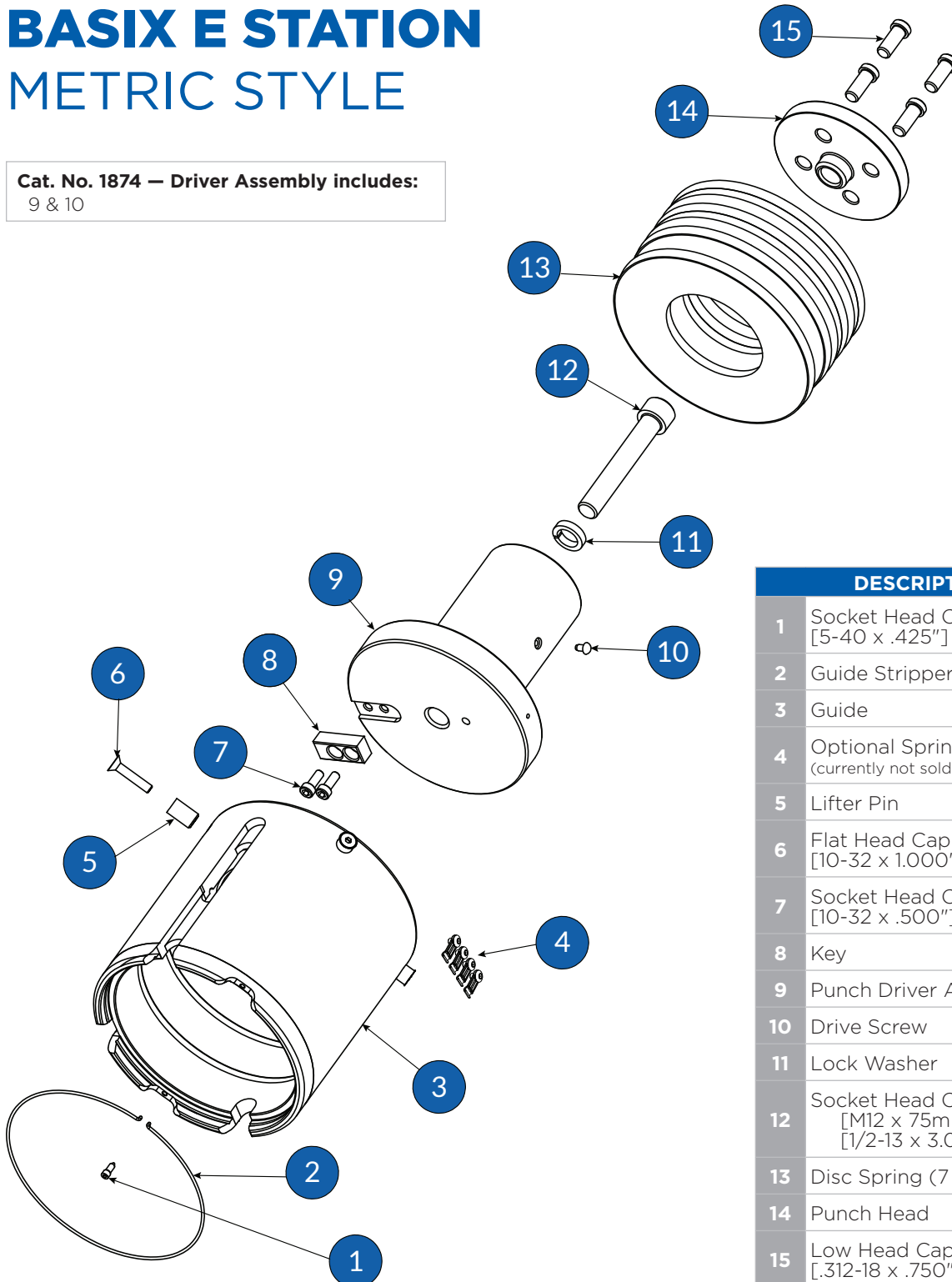

	DESCRIPTION	CAT. NO.
1	Socket Head Cap Screw [5-40 x .425"]	429
2	Guide Stripper Ring	5037
3	Guide	1875
4	Optional Spring Clips (4) (currently not sold with guide)	2810
5	Lifter Pin	1880
6	Flat Head Cap Screw [10-32 x 1.000"]	2158
7	Socket Head Cap Screw [10-32 x .500"]	6010
8	Key	1862
9	Punch Driver Assembly	1874
10	Drive Screw	6666
11	Lock Washer	432
12	Socket Head Cap Screw (2) [M12 x 75mm] [1/2-13 x 3.000"]	6027 6003
13	Disc Spring (7 required)	1859
14	Punch Head	1873
15	Low Head Cap Screw [.312-18 x .750"]	6022