



OSAS + OSM = OVER STROKE ACTIVE SAFETY + OVER STROKE MARKER

ACTIVE SAFETY

easyl MANIFOLD p. 211



OSAS

* F_{1i} = Isothermal end force at 100% Cu p. 16

** F_{1p} = Polytropic end force at 100% Cu p. 16



USAS

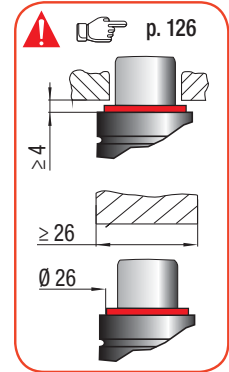
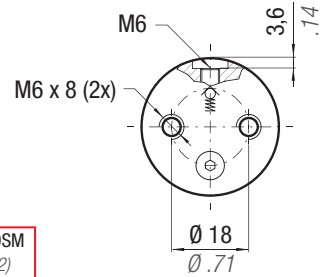
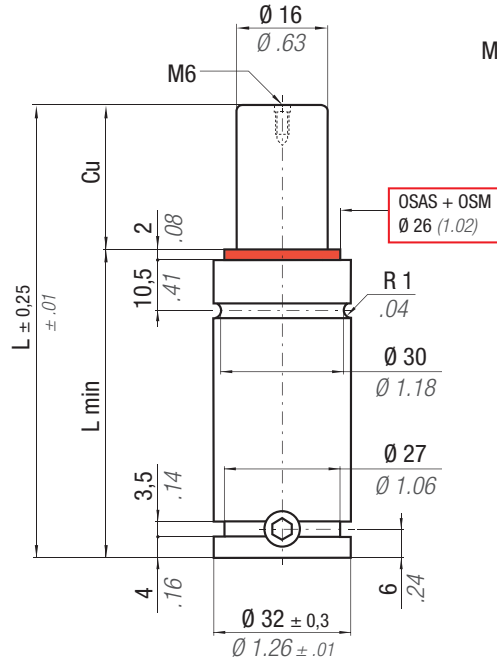

CODE	N ₂	°F 32 - 176	°C 0 - 80	ΔP ± 0,33 %/°C	P max 150 bar 2175 psi	P min 20 bar 290 psi	S 2,01 cm ² 0,312 in ²	SPM ~ 30 ÷ 100 (at 20°C)	Max Speed 1,8 m/s	Maintenance kit 39BMRV00350C	Cu		L		L min		F ₀		F _{1i} *		F _{1p} **		V ₀		PED 2014/68/EU		
											mm	inch	mm	inch	mm	inch	daN	lb	daN	lb	daN	lb	cm ³	in ³	~Kg	~lb	✓
H 300 - 010 - C											10	0.39	70	2.76	60	2.36	300 ± 5% 150 bar 2175 psi + 20 °C +68 °F	350	787	385	865	17,0	1.04	0,22	0.49	✓	✓
H 300 - 013 - C										13	0.51	75,7	2.98	62,7	2.47	361		811	400	900	19,0	1.16	0,23	0.51	✓	✓	
H 300 - 016 - C										16	0.63	82	3.23	66	2.60	369		829	412	927	21,0	1.28	0,24	0.53	✓	✓	
H 300 - 025 - C										25	0.98	100	3.94	75	2.95	389		875	443	995	26,0	1.59	0,26	0.57	✓	✓	
H 300 - 038 - C										38	1.50	126	4.96	88	3.46	409		919	473	1062	34,0	2.07	0,31	0.68	✓	✓	
H 300 - 050 - C										50	1.97	150	5.91	100	3.94	421		947	492	1105	41,0	2.50	0,35	0.77	✓	✓	
H 300 - 063 - C										63	2.48	176,5	6.95	113,5	4.47	430		966	505	1136	49,0	2.99	0,39	0.86	✓	✓	
H 300 - 080 - C										80	3.15	210	8.27	130	5.12	440		989	521	1171	59,0	3.60	0,44	0.97	✓	✓	
H 300 - 100 - C										100	3.94	250	9.84	150	5.91	448		1006	533	1199	71,0	4.33	0,51	1.12	✓	✓	
H 300 - 125 - C										125	4.92	300	11.81	175	6.89	454		1022	544	1223	86,0	5.25	0,59	1.30	✓	✓	

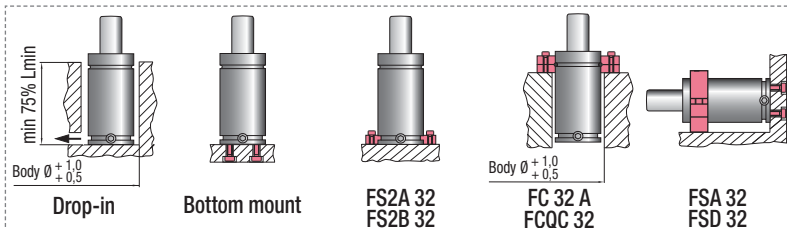

HOW TO ORDER
(10 pcs) H 300-050-C
(10 pcs) H 300-050-C-N