

RV 750

ISO 11901 - 3 B8 3180 220 000 004(MB)	VDI 3003 - Blatt 3 E24.54.815.G (PSA)	B2 4005 (BMW) 39D 997 (VW)	W-DX35-6204 (Ford)
--	--	-------------------------------	--------------------



OSAS + OSM = OVER STROKE ACTIVE SAFETY + OVER STROKE MARKER

ACTIVE SAFETY

easyl MANIFOLD p. 211



OSAS

* F_{1i} = Isothermal end force at 100% Cu p. 16

** F_{1p} = Polytrophic end force at 100% Cu



USAS



OPAS

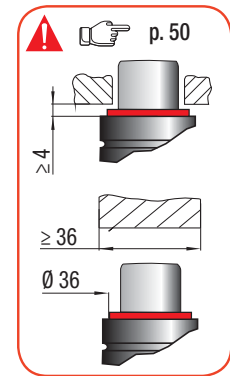
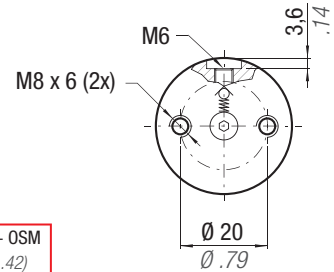
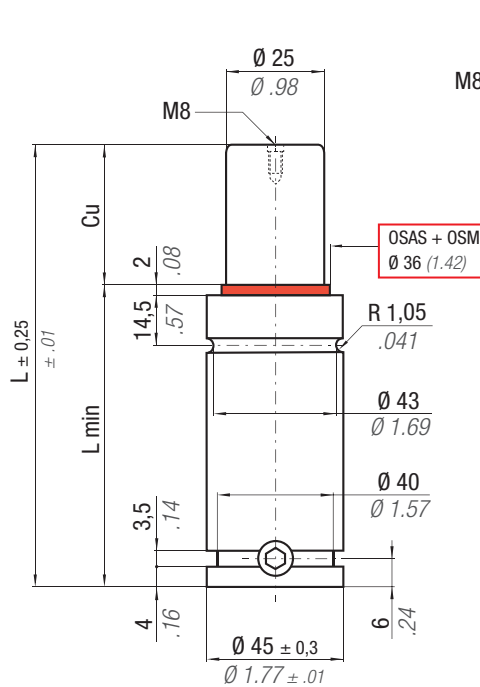

	$^{\circ}\text{F}$ 32 - 176	$^{\circ}\text{C}$ 0 - 80	ΔP $\pm 0,33\% / ^{\circ}\text{C}$	P max 150 bar 2175 psi	P min 20 bar 290 psi	S 4,91 cm ² 0,761 in ²	SPM ~ 20 - 100 (at 20°C)	Max Speed 1,8 m/s	Maintenance kit 39BMRV00750C
--	--------------------------------------	------------------------------------	---	-------------------------------------	-----------------------------------	---	---------------------------------------	-----------------------------	--

CODE	Cu		L		L min		F ₀		F _{1i} *		F _{1p} **		V ₀		PED		
	mm	inch	mm	inch	mm	inch	daN	lb	daN	lb	daN	lb	cm ³	in ³	~Kg	~lb	2014/68/EU
RV 750 - 010 - A	10	0.39	52	2.05	42	1.65	740 ± 5%	1664	1091	2452	1298	2918	18,0	1.10	0,36	0,79	✓
RV 750 - 013 - A	13	0.51	58	2.28	45	1.77			1125	2530	1354	3044	21,0	1.28	0,38	0,84	✓
RV 750 - 016 - A	16	0.63	64	2.52	48	1.89			1151	2587	1395	3136	25,0	1.53	0,40	0,88	✓
RV 750 - 019 - A	19	0.75	70	2.76	51	2.01			1170	2631	1426	3206	29,0	1.77	0,42	0,93	✓
RV 750 - 025 - A	25	0.98	82	3.23	57	2.24			1198	2694	1471	3307	37,0	2.26	0,45	0,99	✓
RV 750 - 032 - A	32	1.26	96	3.78	64	2.52			1220	2742	1506	3386	46,0	2.81	0,50	1.10	✓
RV 750 - 038 - A	38	1.50	108	4.25	70	2.76			1232	2771	1527	3433	53,0	3.23	0,54	1.19	✓
RV 750 - 050 - A	50	1.97	132	5.20	82	3.23			1250	2810	1556	3498	68,0	4.15	0,61	1.34	✓
RV 750 - 063 - A	63	2.48	158	6.22	95	3.74			1262	2838	1577	3545	85,0	5.19	0,70	1.54	✓
RV 750 - 075 - A	75	2.95	182	7.17	107	4.21			1270	2855	1590	3574	100,0	6.10	0,78	1.72	✓
RV 750 - 080 - A	80	3.15	192	7.56	112	4.41	1273	2861	1594	3583	107,0	6.53	0,81	1.79	✓		
RV 750 - 100 - A	100	3.94	232	9.13	132	5.20	1281	2879	1607	3613	132,0	8.05	0,94	2.07	✓		
RV 750 - 125 - A	125	4.92	282	11.10	157	6.18	1287	2894	1618	3637	164,0	10.00	1,10	2.43	✓		

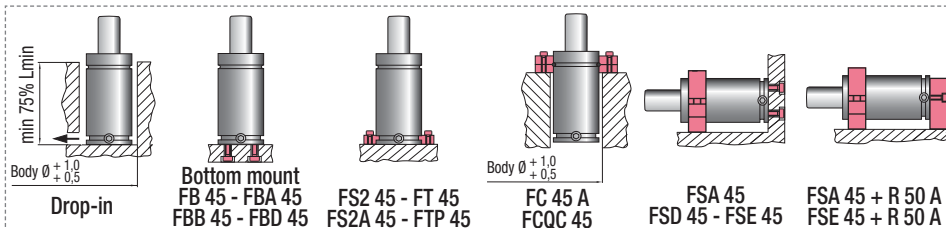

HOW TO ORDER
(10 pcs) RV 750-050-A
(10 pcs) RV 750-050-A-N