

ISO 11901 - 1	VDI 3003	B2 4006 (BMW)	075.90.55 (FCA)
W-DX35-6203 (Ford)	PG23D (Mazda)	B8 3180 220 000 001(MB)	E24.54.815.G (PSA)
EM24.54.700 (Renault)	39D 878 (VW)		



ACTIVE SAFETY



OSAS



USAS



OPAS

OSAS + OSM = OVER STROKE ACTIVE SAFETY + OVER STROKE MARKER

Il nuovo codice sarà fornito solo ad esaurimento del vecchio
 The new code will be supplied only when the old will be out of stock
 Der neue Kode wird geliefert nur wenn der alte nicht mehr im Lager ist
 Le nouveau code sera fourni uniquement lorsque le vieux stock sera écoulé
 El nuevo código será suministrado sólo cuando el viejo está fuera de stock
 O novo código irá ser fornecido apenas quando o antigo esgotar stock

easu MANIFOLD p. 211

* F_{1i} = Isothermal end force at 100% Cu p. 16
 ** F_{1p} = Polytrophic end force at 100% Cu

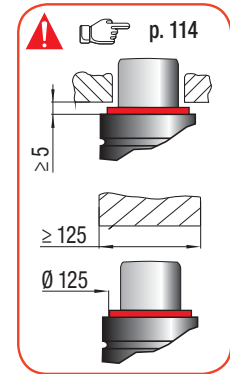
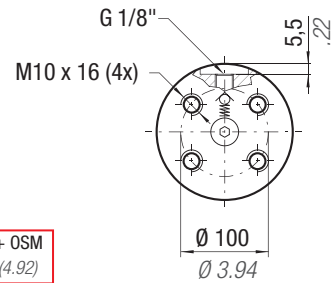
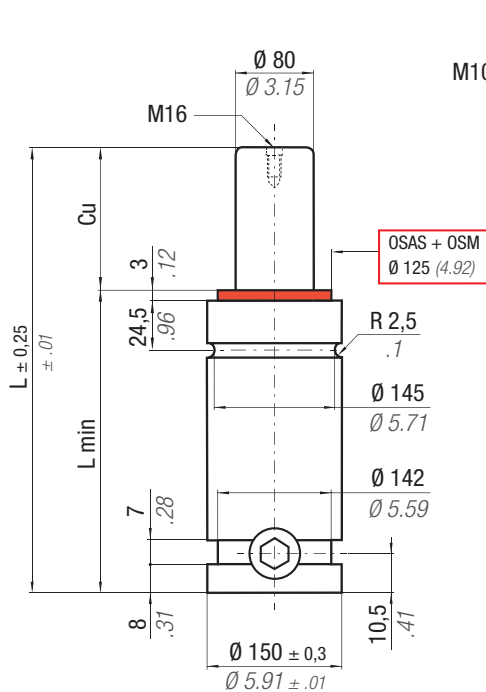

N ₂	°F 32 176	°C 0 80	ΔP ± 0,33 %/°C	P max 150 bar 2175 psi	P min 20 bar 290 psi	S 50,27 cm ² 7.792 in ²	SPM ~ 15 - 50 (at 20°C)	Max Speed 1,8 m/s	Maintenance kit 39BMSOC07500D Cu 25 ÷ 80 39BMSOC07500DH Cu 88 ÷ 300
----------------	-----------------	---------------	-------------------	------------------------------	----------------------------	---	-------------------------------	----------------------	---

CODE PHASING OUT from 01/2014	NEW	Cu		L		L min		F ₀		F _{1i} *		F _{1p} **		V ₀		~Kg	~lb	PED 2014/68/EU
		mm	inch	mm	inch	mm	inch	daN	lb	daN	lb	daN	lb	cm ³	in ³			
SC 7500 - 025 - B	SC 7500 - 025 - D	25	0.98	205	8.07	180	7.09	7500 ± 5%	16950	9330	20975	10472	23543	767,0	46.79	18,71	41.25	✓
SC 7500 - 038 - B	SC 7500 - 038 - D	38	1.50	231	9.09	193	7.60			9809	22052	11192	25161	963,0	58.74	19,50	42.99	✓
SC 7500 - 050 - B	SC 7500 - 050 - D	50	1.97	255	10.04	205	8.07			10129	22771	11679	26255	1144,0	69.78	20,24	44.62	✓
SC 7500 - 063 - B	SC 7500 - 063 - D	63,5	2.50	282	11.10	218,5	8.60			10400	23380	12095	27191	1348,0	82.23	21,06	46.43	✓
-	SC 7500 - 075 - D	75	2.95	305	12.1	230	9.06			10581	23787	12375	27820	1522,0	92.84	21,76	47.97	✓
SC 7500 - 080 - B	SC 7500 - 080 - D	80	3.15	315	12.40	235	9.25			10648	23938	12480	28057	1597,0	97.42	22,07	48.66	✓
-	SC 7500 - 088 - D	88	3.46	330	12.99	242	9.53			10778	24230	12682	28510	1706,0	104.07	22,45	49.49	✓
SC 7500 - 100 - B	SC 7500 - 100 - D	100	3.94	355	13.98	255	10.04			10871	24439	12828	28838	1899,0	115.84	23,23	51.21	✓
-	SC 7500 - 113 - D	113	4.45	380	14.96	267	10.51			11013	24758	13051	29340	2083,0	127.06	23,98	52.87	✓
SC 7500 - 125 - B	SC 7500 - 125 - D	125	4.92	405	15.94	280	11.02			11073	24893	13146	29553	2276,0	138.84	24,76	54.59	✓
-	SC 7500 - 138 - D	138	5.43	430	16.93	292	11.50			11182	25138	13318	29940	2460,0	150.06	25,51	56.24	✓
-	SC 7500 - 150 - D	150	5.91	455	17.91	305	12.1			11222	25228	13382	30084	2654,0	161.89	26,28	57.94	✓
SC 7500 - 160 - B	SC 7500 - 160 - D	160	6.30	475	18.70	315	12.40			11272	25340	13459	30258	2805,0	171.11	26,90	59.30	✓
-	SC 7500 - 175 - D	175	6.89	505	19.88	330	12.99			11337	25487	13563	30491	3031,0	184.89	27,81	61.31	✓
SC 7500 - 200 - B	SC 7500 - 200 - D	200	7.87	555	21.85	355	13.98			11427	25689	13707	30815	3409,0	207.95	29,34	64.68	✓
-	SC 7500 - 225 - D	225	8.86	605	23.82	380	14.96			11501	25855	13824	31078	3786,0	230.95	30,87	68.06	✓
SC 7500 - 250 - B	SC 7500 - 250 - D	250	9.84	655	25.79	405	15.94			11562	25992	13921	31296	4164,0	254.00	32,39	71.41	✓
-	SC 7500 - 275 - D	275	10.83	705	27.76	430	16.93			11613	26107	14003	31480	4541,0	277.00	33,92	74.78	✓
SC 7500 - 300 - B	SC 7500 - 300 - D	300	11.81	755	29.72	455	17.91			11657	26206	14073	31637	4919,0	300.06	35,45	78.15	✓

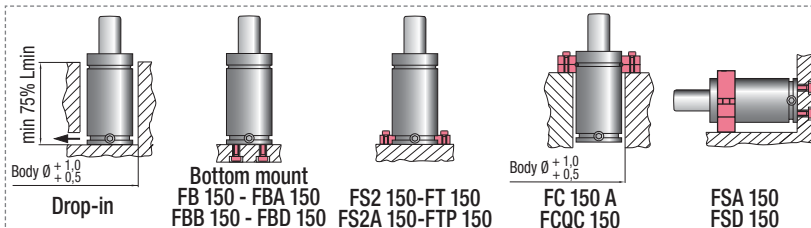

HOW TO ORDER

(10 pcs) SC 7500-050-D
 (10 pcs) SC 7500-050-D-N