

## STANDARD C STATION METRIC STYLE

**Cat. No. 5420 – Guide Unit Assembly includes:**

1, 2, 4, 5, &amp; 6

**Cat. NO. 5729 – Driver Assembly includes:**

15, 16, 17, 18, 19, 20, 21, 22, 23, 24, 25 &amp; 26

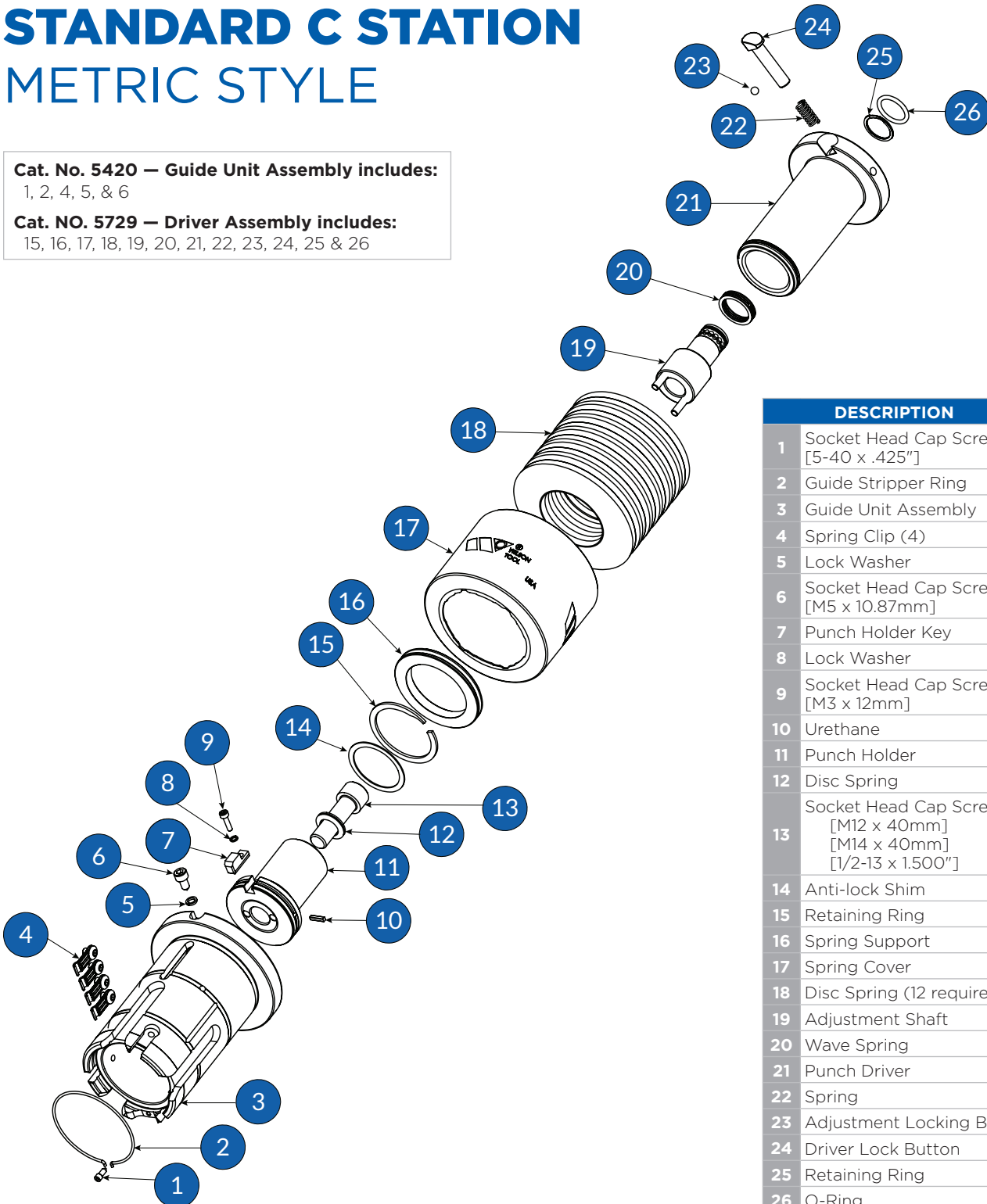

	DESCRIPTION	CAT. NO.
1	Socket Head Cap Screw [5-40 x .425"]	429
2	Guide Stripper Ring	5035
3	Guide Unit Assembly	5420
4	Spring Clip (4)	2810
5	Lock Washer	2112
6	Socket Head Cap Screw [M5 x 10.87mm]	5197
7	Punch Holder Key	5373
8	Lock Washer	6327
9	Socket Head Cap Screw [M3 x 12mm]	6326
10	Urethane	2020643
11	Punch Holder	5556
12	Disc Spring	971690
13	Socket Head Cap Screw [M12 x 40mm] [M14 x 40mm] [1/2-13 x 1.500"]	6605 13843 6606
14	Anti-lock Shim	5412
15	Retaining Ring	972570
16	Spring Support	5748
17	Spring Cover	5693
18	Disc Spring (12 required)	5744
19	Adjustment Shaft	5735
20	Wave Spring	971692
21	Punch Driver	5736
22	Spring	972396
23	Adjustment Locking Ball	972420
24	Driver Lock Button	10539
25	Retaining Ring	972441
26	O-Ring	972430